

TM-Mountings are widely used for the suspension of compressor skids and cooling equipment. These mountings are designed for loads from 3 kN to 20 kN and have natural frequencies of less than 4 Hz. The mountings have high deflection capabilities and offer superior acoustic performance. TM-Mountings have a long service life and can withstand shocks loads of 3 to 5 g without damage.

Load capacity: 1000 to 20000 N

Applications: chiller units, general cooling equipment, compressor-units etc.



LOAD CHARACTERISTICS 10-TM-2000-H

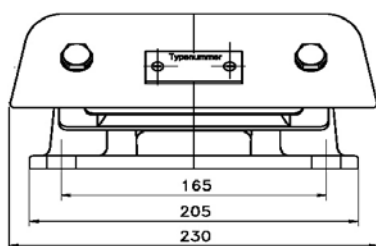
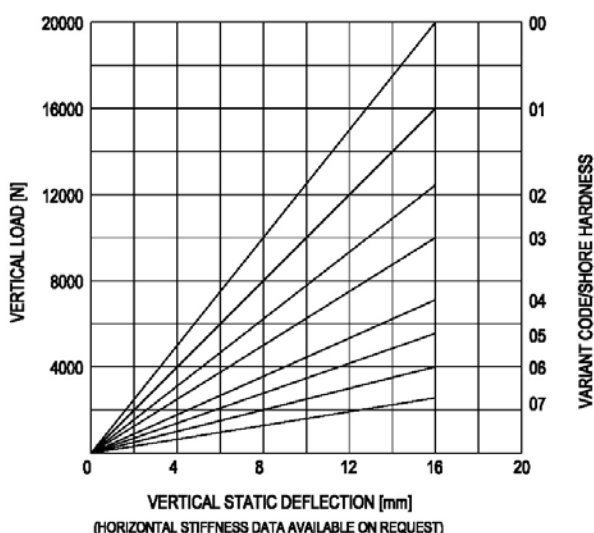

Typenr. 10-TM-2000-H

LOAD CHARACTERISTICS 10-TM-2000-N

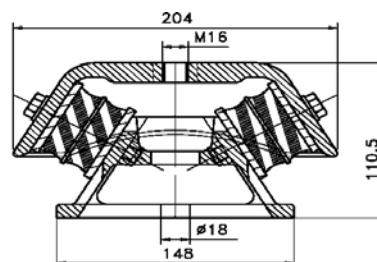
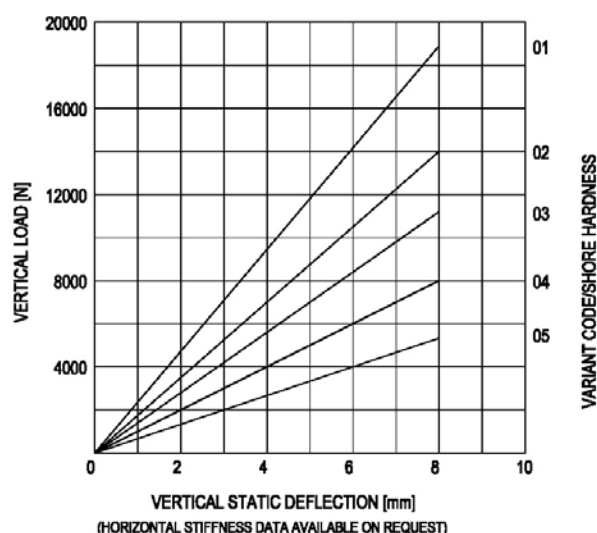

Typenr. 10-TM-2000-N

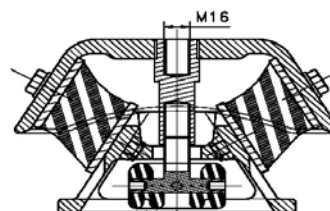
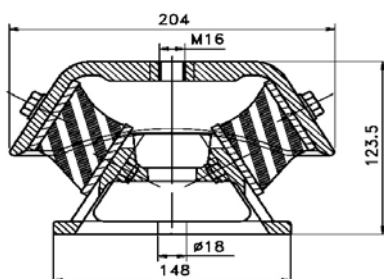

Typenr. 10-TM-2000-T